

High Power

SEN Louvre CV 047 RGBW Fixture Guide

KKDÖ



Indoor/Outdoor | Surface | Output up to 2784lm/m (849lm/ft)

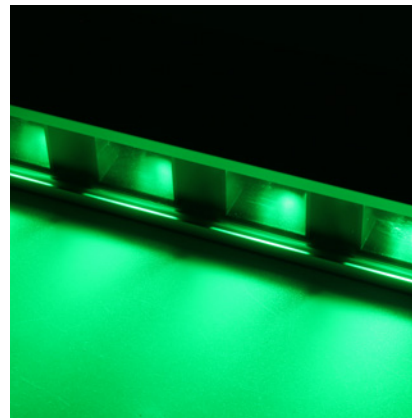
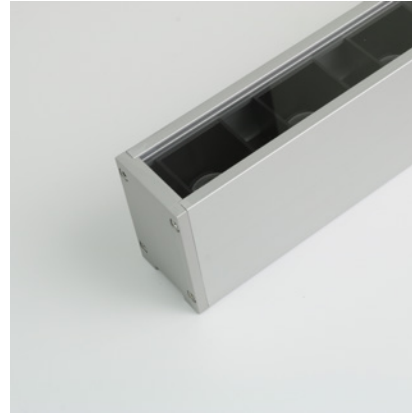

Key applications

- ✓ Building facades
- ✓ Ceiling pendant
- ✓ Direct lighting
- ✓ Downlighting
- ✓ Exterior
- ✓ Flood lighting
- ✓ Public spaces
- ✓ Retail display
- ✓ Special effect
- ✓ Wall grazing
- ✓ Wall mounting
- ✓ Window reveal
- ✓ Wet area

Key features

- ✓ Adjustable
- ✓ Custom lengths
- ✓ Constant Voltage (CV)
- ✓ Diffusion: spotting
- ✓ Glare control options
- ✓ IP44 moisture resistant
- ✓ IP67 waterproof
- ✓ LEDmix RGBW
- ✓ Lens options

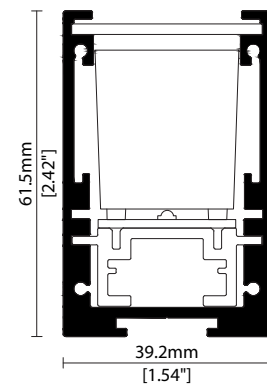

MOUNTING METHODS



KKBK-02 Fixed bracket



KKBK-09 Mounting plate



KKBK-16 Small adjustable bracket



KKBK-17 Large adjustable bracket



KKBK-23 Low adjustable bracket



KKSU-05 Quick release suspension wire kit



SEN Louvre CV 047 RGBW

Specification sheet



Dimensions	H61.5/W39.2/L340-1990mm (H2.42/W1.54/L13.39-78.34in)
PCB Cut-point	330mm (13in)
LED Pitch	47.2mm - 21LED/m (1.85in - 7LED/ft)
Chip	RGBW LEDmix
Cover/Optics	15°/25°
CCT	White: 3000K RGB: Red 620-625nm/Blue 455-460nm/Green 520-525nm
LED binning	N/A
CRI	N/A
Lifetime	50,000 hours @ 25°C (50,000 hours @ 77°F)
Operating temp	T _a = -25 to 40°C (T _c max = 82°C) T _a = -13 to 104°F (T _c max = 180°F)
IP Rating	IP44/67
Finish	Silver anodised
Mounting	Surface mounting via brackets
Power feed	Sheathed hardwire tails or male/female connectors
Control*	DMX

*Note: Driving power consumption is Max. 70% of power consumption (RGBW LED should not all be turned on to 100% at the same time)



LED Grading Key

Exclusive Grade

h-line*	*KKDC tuned CCT range
Constant Voltage Lensed High Power LED	
3-step CCT range (4-step for 5000K)	

Power consumption	Supply voltage	Supply current
58W/m (17.68W/ft)	24V DC	2.4A/m (0.74A/ft)

	Clear Cover 15°	Clear Cover 25°
h-line	2784lm/m (849lm/ft) 48lm/W	2668lm/m (813lm/ft) 46lm/W

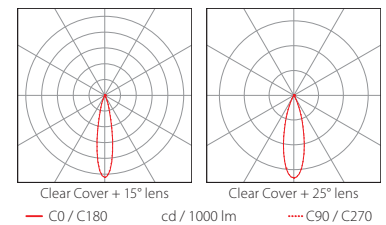
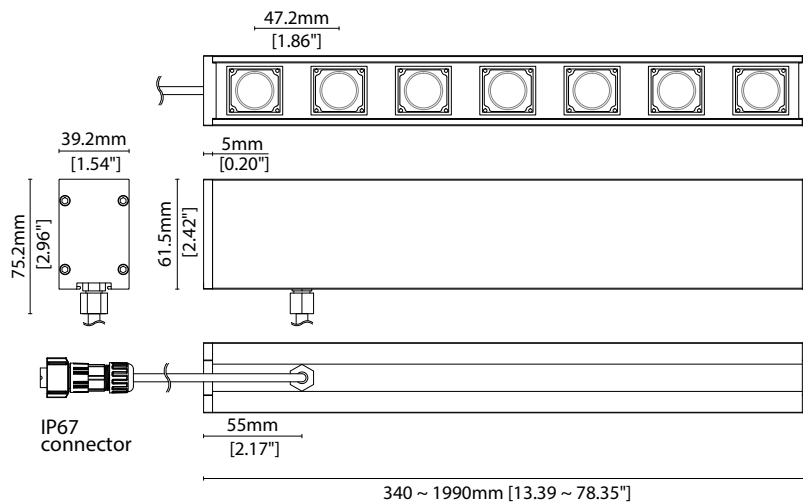

Data derived from independent UKAS/IESNA LM-79-08 accredited testing of production samples.

High Power

SEN Louvre CV 047 RGBW Code Table



FIXTURE

Model	Finish	Cover/Lens ¹	Grade ²	Strip	Colour (CCT)	Length Availability ³	IP	Cable Length	Power Feed ⁴	Cable Exit ⁵	Lens	Input
SEN Louvre	SV Silver Anodised	SA Clear	B h-h	RGBW	RGB+ 3000W	m 340-1990mm 330mm increments i 13.39-78.35in 13in increments (Specify length code OR total run length)	IP44 44 IP67 ⁶ 67	1000mm /39.37" 1000	Single ø6.3mm sheath tail S00B Double ø6.3mm sheath tail D00B Single ø6.3mm sheath IP67 connector S67B Double ø6.3mm sheath IP67 connector D67B	Rear Cable Exit RC Side Cable Exit ⁷ SC	15° 15 25° 25	DC 24V g

- ¹ Refer to **Cover/Lens Options** on **Options** pages ² Refer to **LED Grading Key** on **Specification sheet** page ³ Refer to **Length Availability List** or enter total run length instead of length code
⁴ Refer to **Power Feed Options** on **Options** pages ⁵ Refer to **Cable Exit Options** on **Options** pages
⁶ Due to the clear, flush potted polyurethane top layer on IP67 SEN Louvre CV 047 a colour shift of +/-20K should be expected ⁷ Low adjustable bracket needs side cable exit option

Code Example:

SV	-	SA	-	B	-	h	-	RGBW	-	30	-	m	1330	-	67	-	1000	-	D00B	-	RC	-	25	-	g
SEN Louvre		Silver Anodised		Clear		h-h		RGBW		3000K			1330mm		IP67		1000mm/39.37"		Double ø6.3mm sheath tail		Rear Cable Exit		25°		DC 24V

ACCESSORIES

Mounting Accessories

KKBK-02	Fixed bracket
KKBK-09	Mounting plate
KKBK-16	Small adjustable bracket
KKBK-17	Large adjustable bracket
KKBK-23	Low adjustable bracket
KKSW-05	Quick release

Exterior Junction Boxes

KKJB-07	IP67 Slim J-Box
KKJB-07R	Potting Resin for IP67 Slim J-Box

* Refer to **Exterior Junction Boxes** on **Accessories** pages

* Refer to **Mounting accessories** on **Accessories** pages

LED ENGINE VARIANTS (LED STRIP TYPE)

Colour	LED	Lumen/m	Lumen/ft	W/m	W/ft	Spec Doc	Length	Increment
Single CCT	035	2644	806	40	12.19	SEN Louvre CV 035	260-2010mm (10.24-79.13in)	250mm (9.84in)
RGBW	047 RGBW	2784	849	58	17.68	SEN Louvre CV 047 RGBW	340-1990mm (13.39-78.34in)	330mm (13in)

* Performance data: h-line, 3000K + RGB, clear cover, 10° lens

High Power

SEN Louvre CV 047 RGBW

Length Availability List



Length Code		Fixture Length ¹		LED Strip ²		End Cap Dimension ³		Wattage (W)	Output (lm)
Metric	Imperial(US)	Metric	Imperial(US)	Metric	Imperial(US)	Metric	Imperial(US)		3000K (Test Data)
m0340	i0013	340mm	13.39in	330mm	12.99in	10mm	0.39in	20.63	990
m0670	i0026	670mm	26.38in	660mm	25.98in	10mm	0.39in	41.25	1980
m1000	i0039	1000mm	39.37in	990mm	38.98in	10mm	0.39in	62.50	3000
m1330	i0052	1330mm	52.36in	1320mm	51.97in	10mm	0.39in	82.50	3960
m1660	i0065	1660mm	65.35in	1650mm	64.96in	10mm	0.39in	103.13	4950
m1990	i0078	1990mm	78.35in	1980mm	77.95in	10mm	0.39in	123.75	5940

¹ Actual total overall length of light fixture (LED strip + end caps + void/wire hole)

² Actual length of PCB strip

³ Actual length of 2x end caps

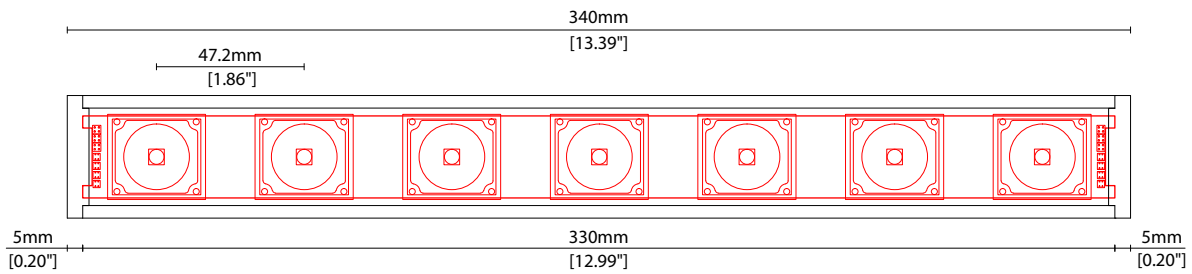



SEN Louvre CV 047 RGBW Options



COVER OPTIONS

* Options are an integral part of the fixture ordering codes. Please refer to **Code Table** pages.

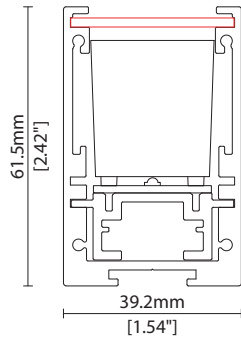

B 15 Clear cover 15° lens
W39.2/H61.5mm (W1.54/H2.42")

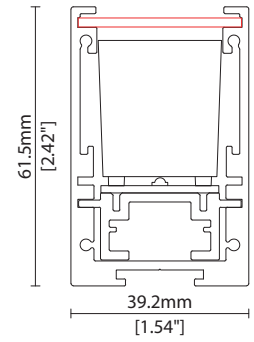

B 25 Clear cover 25° lens
W39.2/H61.5mm (W1.54/H2.42")

CABLE EXIT OPTIONS

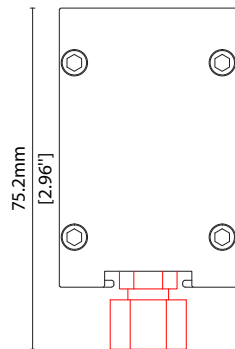

RC Rear cable exit

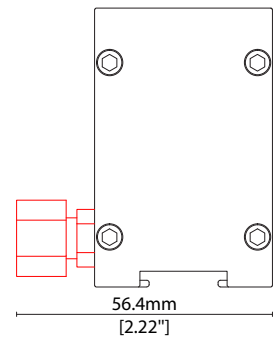

SC Side cable exit

POWER FEED OPTIONS

* Options are an integral part of the fixture ordering codes. Please refer to **Code Table** pages.

1000 S00B 1000mm (39.37") Single ø6.3mm sheath tail

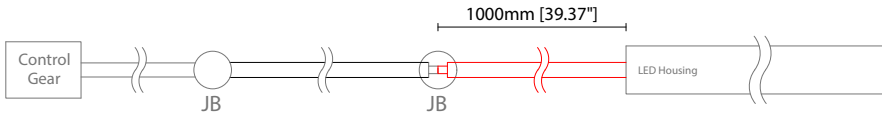

1000 D00B 1000mm (39.37") Double ø6.3mm sheath tail

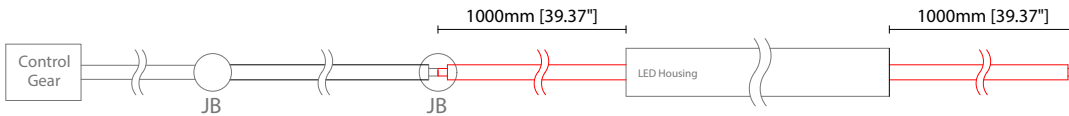

1000 S67B 1000mm (39.37") Single ø6.3mm sheath connector IP67 (Premoulded)

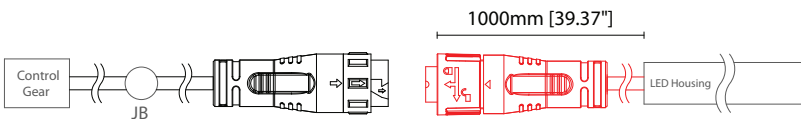

1000 D67B 1000mm (39.37") Double ø6.3mm sheath connector IP67 (Premoulded)

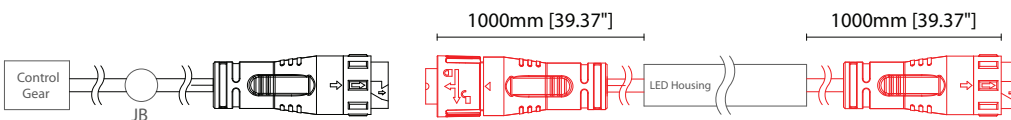

5 Pin RGBW Female Connector IP67 (Premoulded)

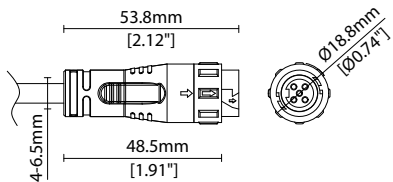

5 Pin RGBW Male Connector IP67 (Premoulded)

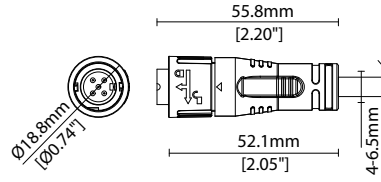

Key

Control Gear Power supply, sub-controllers & control systems

JB Junction box / cable connection

High Power

SEN Louvre CV 047 RGBW Accessories

KKDÖ

MOUNTING ACCESSORIES

Note: Accessories are to be ordered separately with corresponding code shown below.



KKBK-02

Fixed bracket (allow 2 per metre/40in)

S/Steel finish

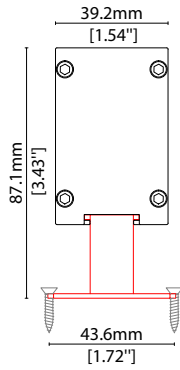

KKBK-09

Mounting plate (allow 2 per metre/40in)

Silver anodised aluminium finish

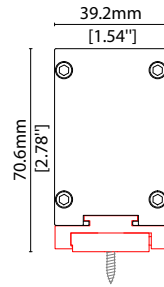

KKBK-23

Low adjustable bracket (allow 2 per metre/40in)

Silver anodised aluminium finish

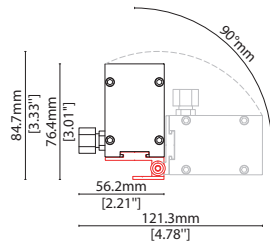

KKBK-16

Small adjustable bracket (allow 2 per metre/40in)

Silver anodised aluminium finish

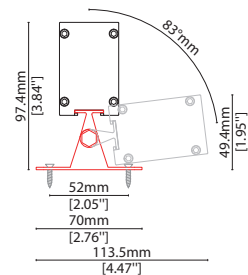

KKBK-17

Large adjustable bracket (allow 2 per metre/40in)

Silver anodised aluminium finish

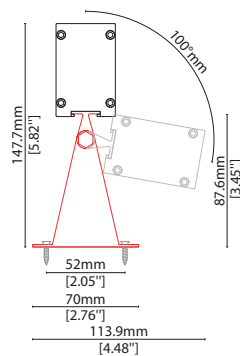

KKSU-05

Quick release suspension wire kit

(1x pair of cables will support up to 2010mm length).

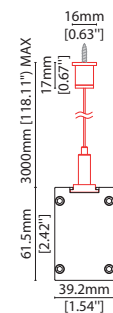



SEN Louvre CV 047 RGBW Accessories



EXTERIOR JUNCTION BOXES



KKJB-07

IP67 Slim J-Box
(including type A,B,C,D bushings)



KKJB-07R

Potting resin for IP67 Slim J-Box



SEN Louvre CV 047 RGBW

Driver/PSU Options



AVAILABLE PSU OPTIONS

Control Mode	PSU (Order Code)	Input Voltage AC	Output Voltage DC	Rated Output Current	Rated Power	Dim %	IP Rating
Switched	CEN-60-24	90-295V	24V	2.5A	60W	-	IP67
	HLG-60H-24	90-305V	24V	2.5A	60W	-	IP67
	HLG-100H-24	90-305V	24V	4.0A	100W	-	IP67
	HLG-150H-24	90-305V	24V	6.3A	150W	-	IP67
	HLG-240H-24	90-305V	24V	10A	240W	-	IP67

¹ PSU and/or driver can be chosen from the table, or KKDC may recommend the best option upon receipt of the controls requirement and installation environment

² Electrical shop drawing will include detailed information of PSU and relevant control drivers

³ Cut sheets are available on the controls section of www.kkdc.lighting or upon request